

QUICK START GUIDE



PARTYBOX 710



BLUETOOTH PAIRING



PLAY

▶|| x1

▶ x2

◀ x3



LIGHTSHOW

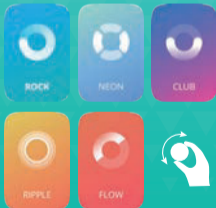
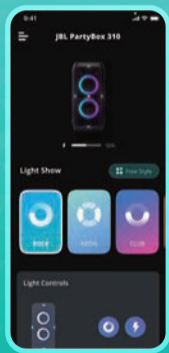

APPLY LIGHTSHOW PRESETS AND MORE WITH THE JBL PARTYBOX APP.

APP



JBL PARTYBOX

DOWNLOAD AND INSTALL THE JBL PARTYBOX APP TO GET MORE FROM THE PRODUCT.

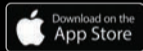

GUITAR



①

②



CHARGING



CONNECT

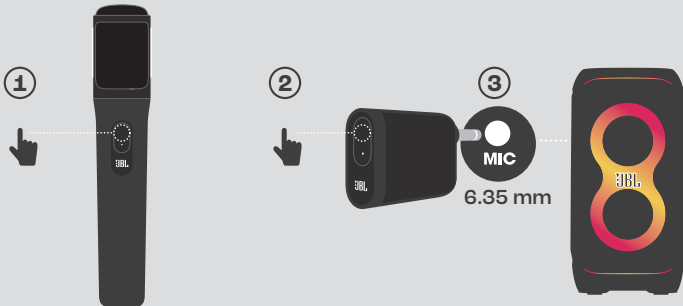

CHARGING

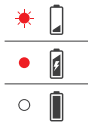
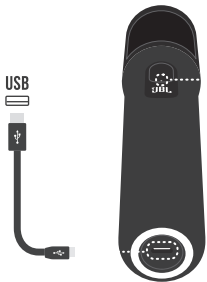

10MIN ⚡ = 2H 🎵 | 20H | 12H 🎵